

Spoljašnji BSPP (colovni) navoj - usećna ivica (ISO 1179) / Unutrašnji BSPP navoj (ISO 1179-1)
 Male BSPP thread – metal sealing edge (ISO 1179) / Female BSPP thread (ISO 1179-1)
 Zöll. Einschraubzapfen – Dichtkante (ISO 1179) / Zöll. Innengewinde (ISO 1179-1)

Slika 1.
 Fig. 1
 Abbildung 1

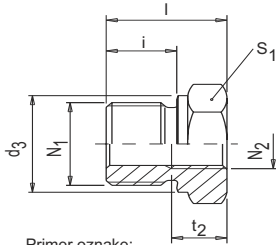

Primer oznake:
 Example for order
 Beispiel der Bezeichnung:

Reducir:
 Reducing adaptor: RU 1/2 - 1/4
 Reduzierstutzen:

Spoljašnji navoj
 Male stud thread
 Aussengewinde

Unutrašnji navoj
 Female thread
 Innengewinde

Slika 2.
 Fig. 2
 Abbildung 2

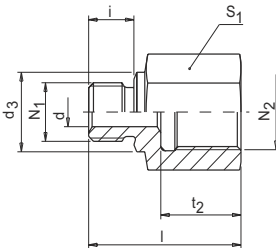

Primer oznake:
 Example for order
 Beispiel der Bezeichnung:

Reducir:
 Reducing adaptor: RU 1/4 - 1/2
 Reduzierstutzen:

Spoljašnji navoj
 Male stud thread
 Aussengewinde

Unutrašnji navoj
 Female thread
 Innengewinde

Cev Ø spoljašnji Tube o.d. Roehn Ø aussen		l	i	S ₁	d	d ₃	t ₂	Slika	Oznaka Part no. Bezeichnung	kg za 100 kom. kg per 100 pcs. kg für 100 St.
N ₁	N ₂									
G 1/8	G 1/4	31	8	19	4	14	17	2	RU 1/8 -	14,6
G 1/8	G 1/8	32	8	24	4	14	17	2	RU 1/8 - 3/8	4,5
G 1/4	G 1/8	28	12	19	5	18	12	2	RU 1/4 - 1/8	3,6
G 1/4	G 3/8	36	12	24	5	18	17	2	RU 1/4 - 3/8	6,6
G 1/4	G 1/2	40	12	30	5	18	20	2	RU 1/4 - 1/2	8,5
G 1/4	G 3/4	43	12	36	5	18	22	2	RU 1/4 - 3/4	17,3
G 3/8	G 1/8	22,5	12	22	-	22	8	1	RU 3/8 - 1/8	4,0
G 3/8	G 1/4	36	12	22	8	22	17	2	RU 3/8 - 1/4	3,0
G 3/8	G 1/2	41	12	30	8	22	20	2	RU 3/8 - 1/2	9,0
G 3/8	G 3/4	44	12	36	8	22	22	2	RU 3/8 - 3/4	17,5
G 1/2	G 1/8	24	14	27	-	26	8	1	RU 1/2 - 1/8	6,7
G 1/2	G 1/4	24	14	27	-	26	12	1	RU 1/2 - 1/4	6,0
G 1/2	G 3/8	36	14	27	12	26	17	2	RU 1/2 - 3/8	9,5
G 1/2	G 3/4	46	14	36	12	26	22	2	RU 1/2 - 3/4	18,0
G 1/2	G 1	49	14	41	12	26	24,5	2	RU 1/2 - 1	22,5
G 1/2	G 1 1/4	53	14	55	10	26	26,5	2	RU 1/2 - 1 1/4	47,0
G 3/4	G 1/4	26	16	32	-	32	12	1	RU 3/4 - 1/4	9,5
G 3/4	G 3/8	26	16	32	-	32	12	1	RU 3/4 - 3/8	9,0
G 3/4	G 1/2	41	16	32	16	32	20	2	RU 3/4 - 1/2	15,0
G 3/4	G 1	51	16	41	16	32	24,5	2	RU 3/4 - 1	23,5
G 3/4	G 1 1/4	55	16	55	16	32	26,5	2	RU 3/4 - 1 1/4	48,2
G 3/4	G 1 1/2	57	16	60	16	32	28,5	2	RU 3/4 - 1 1/2	54,5
G 1	G 1/4	29	18	41	-	39	12	1	RU 1 - 1/4	20,0
G 1	G 3/8	29	18	41	-	39	12	1	RU 1 - 3/8	18,0
G 1	G 1/2	29	18	41	-	39	14	1	RU 1 - 1/2	16,0
G 1	G 3/4	47	18	41	20	39	22	2	RU 1 - 3/4	28,0
G 1	G 1 1/4	57	18	55	20	39	26,5	2	RU 1 - 1 1/4	51,0
G 1	G 1 1/2	59	18	60	20	39	28,5	2	RU 1 - 1 1/2	56,5
G 1 1/4	G 1/2	32	20	50	-	49	14	1	RU 1 1/4 - 1/2	31,0
G 1 1/4	G 3/4	32	20	50	-	49	16	1	RU 1 1/4 - 3/4	27,0
G 1 1/4	G 1	52	20	50	25	49	24,5	2	RU 1 1/4 - 1	45,5
G 1 1/4	G 1 1/2	60	20	60	25	49	28,5	2	RU 1 1/4 - 1 1/2	58,0
G 1 1/2	G 1/2	36	22	55	-	55	14	1	RU 1 1/2 - 1/2	47,0
G 1 1/2	G 3/4	36	22	55	-	55	16	1	RU 1 1/2 - 3/4	43,0
G 1 1/2	G 1	36	22	55	-	55	18	1	RU 1 1/2 - 1	34,5
G 1 1/2	G 1 1/4	58	22	55	32	55	26,5	2	RU 1 1/2 - 1 1/4	53,0
G 2	G 1 1/2	62	24	70	40	68	28,5	2	RU 2 - 1 1/2	58,5

Spoljašnji BSPP (colovni) navoj - MZ zaptivka (ISO 1179) / Unutrašnji BSPP navoj (ISO 1179-1)

Male BSPP thread – MZ-seal (ISO 1179) / Female BSPP thread (ISO 1179-1)

Zöll. Einschraubzapfen – MZ (ISO 1179) / Zöll. Innengewinde (ISO 1179-1)

Slika 1.
Fig. 1
Abbildung 1

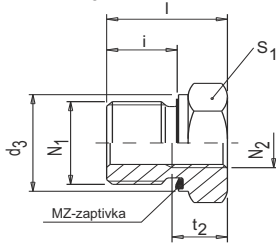

Primer oznake:
Example for order
Beispiel der Bezeichnung:

Reducir:
Reducing adaptor: RU 1/2 - 1/4-MZ
Reduzierstutzen:

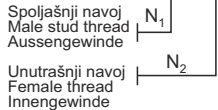

Slika 2.
Fig. 2
Abbildung 2

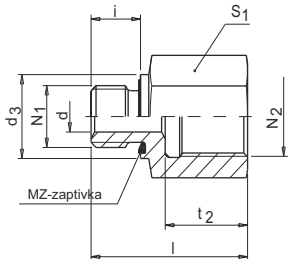

Primer oznake:
Example for order
Beispiel der Bezeichnung:

Reducir:
Reducing adaptor: RU 1/4 - 1/2-MZ
Reduzierstutzen:

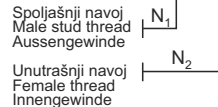

PN	Cev Øspoljašnji Tube o.d. Rohr Øausssen		l	i	S ₁	d	d ₃	t ₂	Silika	Oznaka Part no. Bezeichnung	kg. za 100 kom. kg. per 100 pcs. kg. per 100 St.
	N ₁	N ₂									
630	G 1/8	G 1/4	31	8	19	4	14	17	2	RU 1/8 - 1/4 -MZ	3,9
	G 1/8	G 3/8	32	8	24	4	14	17	2	RU 1/8 - 3/8 -MZ	6,3
	G 1/4	G 1/8	29	12	19	5	19	12	2	RU 1/4 - 1/8 -MZ	3,8
	G 1/4	G 3/8	36	12	24	5	19	17	2	RU 1/4 - 3/8 -MZ	6,7
	G 1/4	G 1/2	40	12	30	5	19	20	2	RU 1/4 - 1/2 -MZ	11,6
	G 1/4	G 3/4	43	12	36	5	19	22	2	RU 1/4 - 3/4 -MZ	17,0
	G 3/8	G 1/8	22,5	12	22	-	22	8	1	RU 3/8 - 1/8 -MZ	3,9
	G 3/8	G 1/4	36	12	22	8	22	17	2	RU 3/8 - 1/4 -MZ	6,8
	G 3/8	G 1/2	41	12	30	8	22	20	2	RU 3/8 - 1/2 -MZ	12,5
400	G 3/8	G 3/4	44	12	36	8	22	22	2	RU 3/8 - 3/4 -MZ	18,3
630	G 1/2	G 1/8	24	14	27	-	27	8	1	RU 1/2 - 1/8 -MZ	6,6
	G 1/2	G 1/4	24	14	27	-	27	12	1	RU 1/2 - 1/4 -MZ	5,6
	G 1/2	G 3/8	37	14	27	12	27	17	2	RU 1/2 - 3/8 -MZ	9,1
400	G 1/2	G 3/4	46	14	36	12	27	22	2	RU 1/2 - 3/4 -MZ	18,2
	G 1/2	G 1	49	14	41	12	27	24,5	2	RU 1/2 - 1 -MZ	22,1
	G 1/2	G 1 1/4	53	14	55	10	27	26,5	2	RU 1/2 - 1 1/4 -MZ	48,2
	G 3/4	G 1/4	26	16	32	-	32	12	1	RU 3/4 - 1/4 -MZ	10,3
	G 3/4	G 3/8	26	16	32	-	32	12	1	RU 3/4 - 3/8 -MZ	8,7
	G 3/4	G 1/2	43	16	32	16	32	20	2	RU 3/4 - 1/2 -MZ	14,3
	G 3/4	G 1	51	16	41	16	32	24,5	2	RU 3/4 - 1 -MZ	23,5
315	G 3/4	G 1 1/4	55	16	55	16	32	26,5	2	RU 3/4 - 1 1/4 -MZ	48,1
400	G 1/4	G 1/2	57	16	60	16	32	28,5	2	RU 3/4 - 1 1/2 -MZ	56,0
	G 1	G 1/4	29	18	41	-	40	12	1	RU 1 - 1/4 -MZ	19,5
	G 1	G 3/8	29	18	41	-	40	12	1	RU 1 - 3/8 -MZ	17,9
	G 1	G 1/2	29	18	41	-	40	14	1	RU 1 - 1/2 -MZ	15,7
	G 1	G 3/4	49	18	41	20	40	22	2	RU 1 - 3/4 -MZ	26,8
	G 1	G 1 1/4	57	18	55	20	40	26,5	2	RU 1 - 1 1/4 -MZ	50,3
	G 1	G 1 1/2	59	18	60	20	40	28,5	2	RU 1 - 1 1/2 -MZ	58,5
	G 1 1/4	G 1/2	32	20	50	-	50	14	1	RU 1 1/4 - 1/2 -MZ	30,8
	G 1 1/4	G 3/4	32	20	50	-	50	16	1	RU 1 1/4 - 3/4 -MZ	26,6
	G 1 1/4	G 1	53	20	50	25	50	24,5	2	RU 1 1/4 - 1 -MZ	45,8
315	G 1 1/4	G 1 1/2	60	20	60	25	50	28,5	2	RU 1 1/4 - 1 1/2 -MZ	61,6
	G 1 1/2	G 1/2	36	22	55	-	55	14	1	RU 1 1/2 - 1/2 -MZ	47,0
	G 1 1/2	G 3/4	36	22	55	-	55	16	1	RU 1 1/2 - 3/4 -MZ	40,2
	G 1 1/2	G 1	36	22	55	-	55	18	1	RU 1 1/2 - 1 -MZ	33,7
	G 1 1/2	G 1 1/4	58	22	55	32	55	26,5	2	RU 1 1/2 - 1 1/4 -MZ	54,2